

FEATURES AND BENEFITS

- Stainless steel handle
- Nickle Plated, zinc die cast button latch
- Stainless steel button dowel
- Stainless steel button spring
- Nickle plated, zinc die cast base
- Stainless steel handle dowel
- 3 screws

RUGGED VPX HANDLE

IEEE 1101.10 COMPLIANT

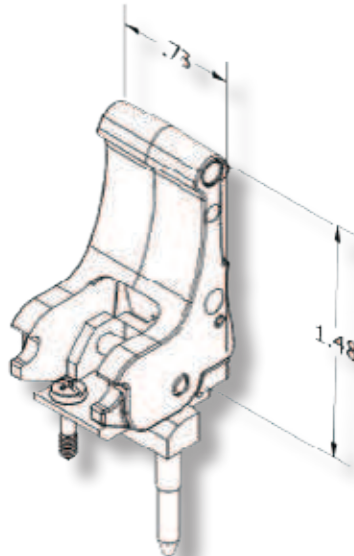

TECHNICAL SPECIFICATIONS

Handle and PCB mounting block

3 screws for PCB, handle, and chassis mounting
(Two SS PHP M2.5 X 6, and SS combo slot M2.5 X 10.5)

Powder coat finish (standard)
Custom finishing (alternate powder coat color, anodizing) also available

Latching button, spring, and handle base are zinc die cast with electroless nickel coating

Total weight: 48.988 grams, 0.811oz

EXTENSIVELY TESTED

- Insertion/Ejection Cycling
- Salt Fog Testing
- Finite Element Analysis
- Material Composition Testing
- First Article Reports



The information in this document is subject to change without notice and should not be construed as a commitment by Atrenne, a Celestica company. While reasonable precautions have been taken, Atrenne assumes no responsibility for any errors that may appear in this document. All products shown or mentioned are trademarks or registered trademarks of their respective owners.